

30W Single Output Industrial DIN Rail Power Supply (HDR-30)



GHDR-30...

Feature

- Universal AC input/ full range
- Protections: Short circuit/ Over load/ Over voltage
- Cooling by free air convection
- Can be installed on DIN rail TS-3.5/7.5 or 15
- Isolation class II
- LED indicator for power on
- 100% full load burn-in test
- 3 years warranty
- Dimensions: 78*93*56mm (W*H*D)

Notes:

- All parameters NOT specially mentioned are measured at 230VAC input, rated load and 25°C of ambient temperature.
- Ripple & noise are measured at 20MHz of bandwidth by using a 12" twisted pair-wire terminated with a 0.1μ & 47μf parallel capacitor.
- Each output can within current range. But total output power can't exceed rated load
- The power supply is considered a component which will be installed into a final equipment. The final equipment must be re-confirmed that it still meets EMC directives.

Model		GHDR-30-5	GHDR-30-12	GHDR-30-15	GHDR-30-24
Output	DC Voltage	5V	12V	15V	24V
	Voltage Tolerance	±2%	±1%	±1%	±1%
	Rated Current	3A	2A	2A	1.5A
	Current Range	0-3A	0-2A	0-2A	0-1.5A
	Rated Power	15W	24W	30W	36W
	Ripple & Noise	80mVp-p	120mVp-p	120mVp-p	150mVp-p
	DC Voltage Adj.Range	-5%, +10%	± 10%	± 10%	± 10%
	Setup,Rise,Hold Time	100ms,30ms/230VAC 100ms,30ms/115VAC at full load			
Input	Voltage Range	85~264 VAC 47-63 Hz; selected by switch 120~370VDC			
	AC Current	0.88 A/115 V 0.48A/ 230 V			
	Efficiency	74%	81%	82%	83%
	Inrush Current	Cold start 15A/115V 30A/230V			
Protection	Over Load	105%~160% Protection type: Constant current limiting, recovers automatically after fault condition is removed			
	Over Voltage	115%~135% Protection type: Shut down o/p voltage, re-power on to recover			
Environment	Working Temp & Humidity	-10°C~-+60°C, 20%~90 %RH			
	Storage Temp & Humidity	-40°C~-+85°C, 10%~95 %RH			
	Vibration	10~500Hz, 2G 10min/1cycle, period for 60min, each along X, Y, Z axes			
Safety	Withstand Voltage	I/P-O/P: 3KVAC			
	Isolation Resistance	I/P-O/P: 100M Ohms / 500VDC			
Standards	Safety Standard	Design refer to UL60950-1,TUV EN60950-1,EN50178			
	EMC Standard	Design refer to EN55011,EN55022,EN61000-3-2,-3,EN61000-4-2,3,4,5,6,8,11, ENV50204,EN55024,EN61000-6-2,EN61204-3			
Others	Weight	0.27Kg			
	Packing	48pcs/14Kg/1.02CUFT			

Outline and dimension

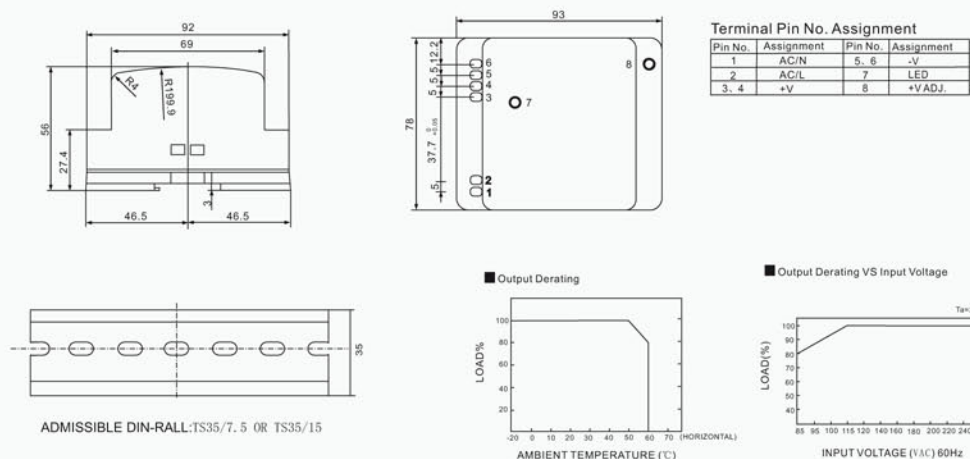

45W Single Output Industrial DIN Rail Power Supply (HDR-45)



GHDR-45...

Feature

- Universal AC input/ full range
- Protections: Short circuit/ Over load/ Over voltage/ Over temperature
- Cooling by free air convection
- Can be installed on DIN rail TS-3.5/7.5 or 15
- LED indicator for power on
- 100% full load burn-in test
- Fixed switching frequency at 100KHz
- 3 years warranty
- Dimensions: 78*97*67mm (L*W*H)

Notes:

- All parameters NOT specially mentioned are measured at 230VAC input, rated load and 25°C of ambient temperature.
- Ripple & noise are measured at 20MHz of bandwidth by using a 12" twisted pair-wire terminated with a 0.1μ & 47μF parallel capacitor.

- Each output can within current range. But total output power can't exceed rated load

- The power supply is considered a component which will be installed into a final equipment. The final equipment must be re-confirmed that it still meets EMC directives.

Model	GHDR-45-5	GHDR-45-12	GHDR-45-15	GHDR-45-24
Output	DC Voltage	5V	12V	15V
	Voltage Tolerance	±2%	±1%	±1%
	Rated Current	5A	3.5A	2.8A
	Current Range	0-5A	0-3.5A	0-2.8A
	Rated Power	25W	42W	42W
	Ripple & Noise	100mVp-p	200mVp-p	240mVp-p
	DC Voltage Adj.Range	4.75-5.5V	10.8-13.2V	13.5-16.5V
	Setup,Rise,Hold Time	800ms,60ms, 100ms/230VAC at full load		
Input	Voltage Range	85~264 VAC 47-63 Hz;selected by switch120~370VDC		
	AC Current	1.5 A/115 V 0.75A/ 230 V		
	Efficiency	72%	77%	80%
	Inrush Current	Cold start 28A/115V 56A/230V		
	Leakage Current	<1mA/240VAC		
Protection	Over Load	105%~150% Protection type: Constant current limiting, recovers automatically after fault condition is removed		
	Over Voltage	115%~135% Protection type: Shut down o/p voltage, re-power on to recover		
	Over Temperature	Tj 135 typically (U1) Detect on heat sink of power transistor, shut down o/p voltage, recovers automatically after temperature goes down		
Environment	Working Temp & Humidity	-10°C~+50°C, 20%~90 %RH		
	Storage Temp & Humidity	-20°C~+85°C, 10%~95 %RH		
	Vibration	10~500Hz, 2G 10min./1cycle, period for 60min, each along X, Y, Z axes		
Safety	Withstand Voltage	I/P-O/P: 3KVAC I/P-FG: 1.5KVAC O/P-FG: 0.5KVAC		
	Isolation Resistance	I/P-O/P, I/P-FG, O/P-FG: 100M Ohms / 500VDC		
Standards	Safety Standard	Design refer to UL508,TUV EN60950-1		
	EMC Standard	Design refer to EN55011,EN55022,EN61000-3-2,-3,EN61000-4-2,3,4,5,6,8,11,ENV50204, EN55024,EN61000-6-2		
Others	Weight	0.31Kg		
	Packing	48pcs/16.1Kg/1.3CUFT		

Outline and dimension

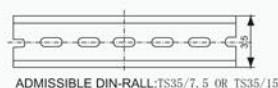
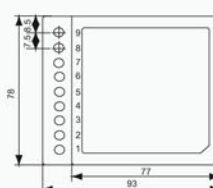
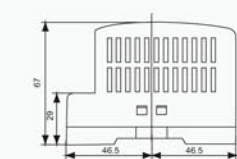

ADMISSIBLE DIN-RAIL:TS35/7.5 OR TS35/15

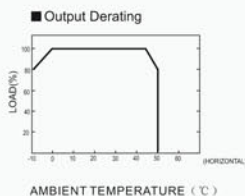

Terminal Pin No. Assignment

Pin No.	Assignment	Pin No.	Assignment	Pin No.	Assignment
1	AC/L	4. 5	DC OUTPUT -V	9	+V ADJ.
2	AC/N	6. 7	DC OUTPUT +V		
3	FG@	8	LED		

■ Static Characteristics(24V)

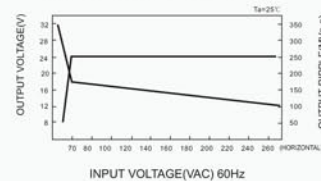

60W Single Output Industrial DIN Rail Power Supply (HDR-60)



GHDR-60...

Feature

- Universal AC input/ full range
- Protections: Short circuit/ Over load/ Over voltage
- Cooling by free air convection
- Can be installed on DIN rail TS-3.5/7.5 or 15
- Isolation class II
- LED indicator for power on
- 100% full load burn-in test
- 3 years warranty
- Dimensions: 78*93*56mm (W*H*D)

Notes:

- All parameters NOT specially mentioned are measured at 230VAC input, rated load and 25°C of ambient temperature.

- Ripple & noise are measured at 20MHz of bandwidth by using a 12" twisted pair-wire terminated with a 0.1μ & 47μf parallel capacitor.

- Each output can within current range. But total output power can't exceed rated load

- The power supply is considered a component which will be installed into a final equipment. The final equipment must be re-confirmed that it still meets EMC directives.

Model		GHDR-60-5	GHDR-60-12	GHDR-60-15	GHDR-60-24
Output	DC Voltage	5V	12V	15V	24V
	Voltage Tolerance	±2%	±1%	±1%	±1%
	Rated Current	6.5A	4.5A	4A	2.5A
	Current Range	0-6.5A	0-4.5A	0-4A	0-2.5A
	Rated Power	32.5W	54W	60W	60W
	Ripple & Noise	80mVp-p	120mVp-p	120mVp-p	150mVp-p
	DC Voltage Adj.Range	-5%, +10%	-8%, +10%	±10%	±10%
	Setup,Rise,Hold Time	100ms,30ms/230VAC at full load 200ms,30ms/115VAC at full load			
	Hoid time	100ms/230VAC 23ms/115VAC at full load			
Input	Voltage Range	88~264 VAC 47-63 Hz; selected by switch 124~370VDC			
	AC Current	1.2A/115 V 0.8A/ 230 V			
	Efficiency	76%	82%	83%	81%
	Inrush Current	Cold start 20A/115V 40A/230V			
	Protection	Over Load	105%~160% Protection type: Constant current limiting, recovers automatically after fault condition is removed		
Over Voltage		115%~135% Protection type: Shut down o/p voltage, re-power on to recover			
Environment	Working Temp & Humidity	-20°C~+60°C, 20%~90 %RH			
	Storage Temp & Humidity	-40°C~+85°C, 10%~95 %RH			
	Vibration	10~500Hz, 2G 10min./1cycle, period for 60min, each along X, Y, Z axes			
Safety	Withstand Voltage	I/P-O/P: 3KVAC			
	Isolation Resistance	I/P-O/P: 100M Ohms / 500VDC			
Standards	Safety Standard	Design refer to UL60950-1,TUV EN60950-1,EN50178			
	EMC Standard	Design refer to EN55011,EN55022,EN61000-3-2,-3,EN61000-4-2,3,4,5,6,8,11,ENV50204,EN55024,EN61000-6-2, EN61204-3			
Others	Weight	0.3Kg			
	Packing	48pcs/15.4Kg/1.02CUFT			

Outline and dimension

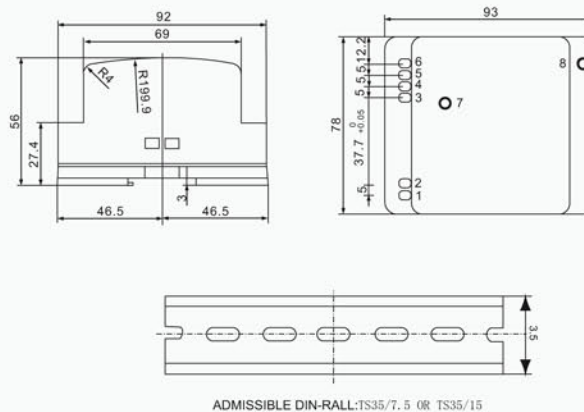

Terminal Pin No. Assignment

Pin No.	Assignment	Pin No.	Assignment
1	AC/N	5, 6	.V
2	AC/L	7	LED
3, 4	+V	8	+V ADJ.

Output Derating

